

5

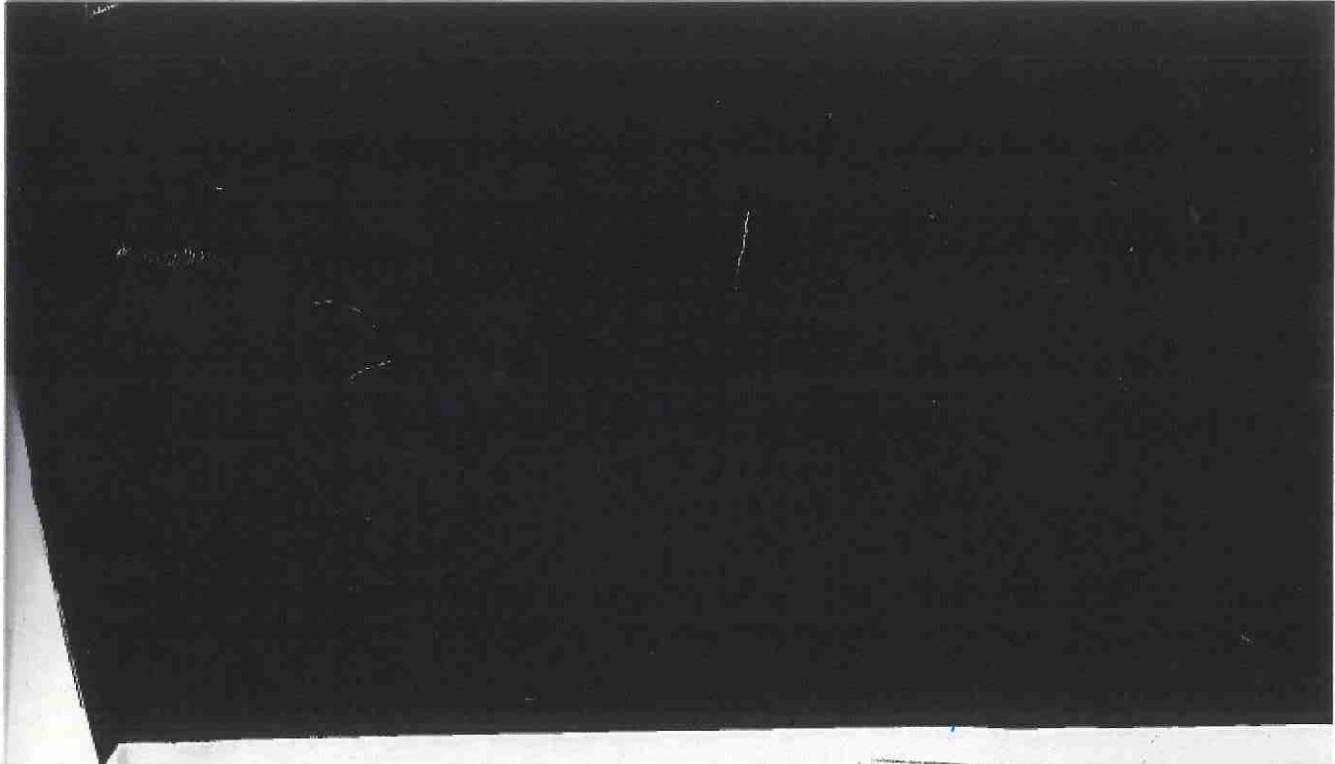

LETTER TO THE CONVEYANCING SOLICITOR

Certified a True Copy
Angela Hocking
Director for Essex Legal Services

25/10/16

Appropriation of Property -
Wickham Bishops Branch Library, School Road

The Estates and Architectural Services Committee on 29 January 1985 (Minute N) gave approval for the appropriation of the above property having an area of 0.24 acre (0.1 hectare) from Highways to Library purposes. Accordingly, in accordance with the usual procedure, I attach for deposit with the Title Deed a certified copy of the agenda item and minute, together with a plan showing the site concerned. The valuation is given in the agenda item.

I am not aware of any other consents or approvals which are required for this appropriation. Please will you arrange for any amendment of the Land Certificate if this is necessary.

Beryl P. G. Head

Ref: BH EA.318.01/648
Ext. 2030
26 March 1985

MC

See C/TL MISC 397 sent to Mike Lewis

318.01/618

EXTRACT FROM THE AGENDA AND MINUTES OF THE ESTATES AND ARCHITECTURAL SERVICES

COMMITTEE HELD ON 29 January 1985

15. APPROPRIATION OF PROPERTY - WICKHAM BISHOPS BRANCH LIBRARY, SCHOOL ROAD

This building was originally a Church of England school and was purchased by the Council for road improvements in 1972. It has been leased since March, 1973 to the Library Museum and Records Committee for use as a Branch Library. The property is now surplus to highways requirements, subject to the retention of a small area of car parking. It is therefore

RECOMMENDED:

That the Wickham Bishops Branch Library having an area of 0.24 acre (0.1 hectare), be appropriated from highways to library purposes at a value of £30,000.

DECIDED:

15. APPROPRIATION OF PROPERTY - WICKHAM BISHOPS BRANCH LIBRARY, SCHOOL ROAD

The report of the County Estates Officer and Valuer (agenda item 15) was received.

RESOLVED:

That the recommendation in agenda item 15 be adopted.

I certify the above to be a true extract from the agenda and minutes of the Estates and Architectural Services Committee held on 29 January 1985.

Date: 26 March 1985

Beryl P.E. Heard
.....
for Chief Executive and Clerk
(Mrs B.P.E. Heard)

N
CITY COUNCIL RECORDS
C/TE
277

For main deeds
see also MICR 207

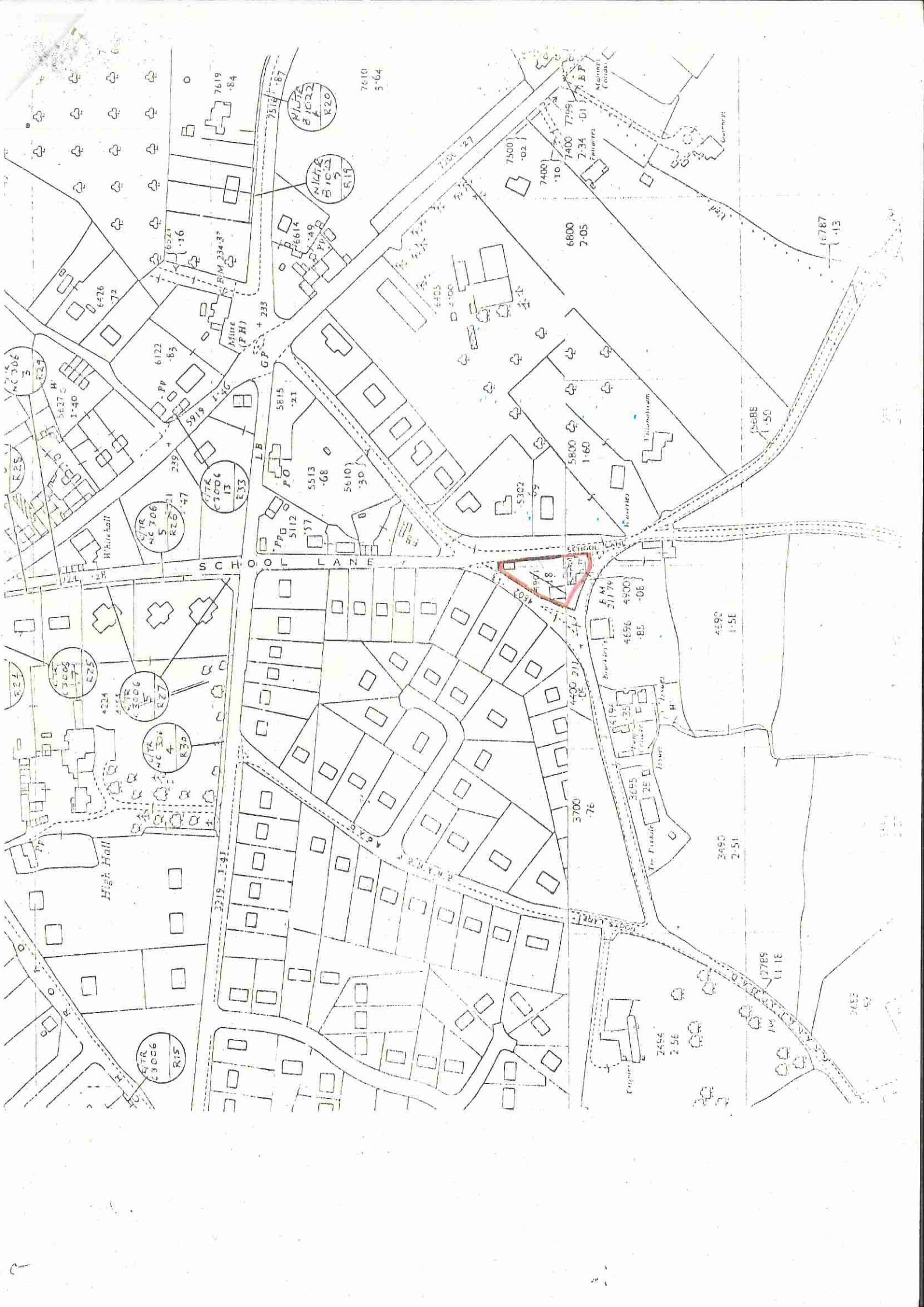

7
6

6426
72

6427
71

6428
70

6429
69

6430
68

6431
67

6432
66

6433
65

6434
64

6435
63

6436
62

6437
61

6438
60

6439
59

6440
58

6441
57

6442
56

6443
55

6444
54

7619
84

7518
87

7400
10

7300
02

7200
01

7100
01

7000
01

6900
01

6800
05

6700
05

6600
05

6500
05

6400
05

6300
05

6200
05

6100
05

6000
05

5900
05

5800
05

5700
05

5600
05

5500
05

5400
05

5300
05

5200
05

5100
05

5000
05

4900
05

4800
05

4700
05

4600
05

4500
05

4400
05

5615
21

5513
68

5610
30

5112
37

5110
37

5108
37

5106
37

5104
37

5102
37

5100
37

5098
37

5096
37

5094
37

5092
37

5090
37

5088
37

5086
37

5084
37

5082
37

5080
37

5078
37

5076
37

5074
37

5072
37

5070
37

5068
37

5066
37

5064
37

5062
37

5060
37

5058
37

5056
37

5054
37

7610
64

7500
02

7400
10

7300
02

7200
01

7100
01

7000
01

6900
05

6800
05

6700
05

6600
05

6500
05

6400
05

6300
05

6200
05

6100
05

6000
05

5900
05

5800
05

5700
05

5600
05

5500
05

5400
05

5300
05

5200
05

5100
05

5000
05

4900
05

4800
05

4700
05

4600
05

4500
05

4400
05

5615
21

5513
68

5610
30

5112
37

5110
37

5108
37

5106
37

5104
37

5102
37

5100
37

5098
37

5096
37

5094
37

5092
37

5090
37

5088
37

5086
37

5084
37

5082
37

5080
37

5078
37

5076
37

5074
37

5072
37

5070
37

5068
37

5066
37

5064
37

5062
37

5060
37

5058
37

5056
37

5054
37

7610
64

7500
02

7400
10

7300
02

7200
01

7100
01

7000
01

6900
05

6800
05

6700
05

6600
05

6500
05

6400
05

6300
05

6200
05

6100
05

6000
05

5900
05

5800
05

5700
05

5600
05

5500
05

5400
05

5300
05

5200
05

5100
05

5000
05

4900
05

4800
05

4700
05

4600
05

4500
05

4400
05

5615
21

5513
68

5610
30

5112
37

5110
37

5108
37

5106
37

5104
37

5102
37

5100
37

5098
37

5096
37

5094
37

5092
37

5090
37

5088
37

5086
37

5084
37

5082
37

5080
37

5078
37

5076
37

5074
37

5072
37

5070
37

5068
37

5066
37

5064
37

5062
37

5060
37

5058
37

5056
37

5054
37

7610
64

7500
02

7400
10

7300
02

7200
01

7100
01

7000
01

6900
05

6800
05

6700
05

6600
05

6500
05

6400
05

6300
05

6200
05

6100
05

6000
05

5900
05

5800
05

5700
05

5600
05

5500
05

5400
05

5300
05

5200
05

5100
05

5000
05

4900
05

4800
05

4700
05

4600
05

4500
05

4400
05

5615
21

5513
68

5610
30

5112
37

5110
37

5108
37

5106
37

5104
37

5102
37

5100
37

5098
37

5096
37

5094
37

5092
37

5090
37

5088
37

5086
37

5084
37

5082
37

5080
37

5078
37

5076
37

5074
37

5072
37

5070
37

5068
37

5066
37

5064
37

5062
37

5060
37

5058
37

5056
37

5054
37

7610
64

7500
02

7400
10

7300
02

7200
01

7100
01

7000
01

6900
05

6800
05